

# CONSTRUCTION DETAILS

W.C.P.C. 1009  
"CONCRETE CURB WALLS"  
BARKER ROAD NON-MOTORIZED  
PATHWAY

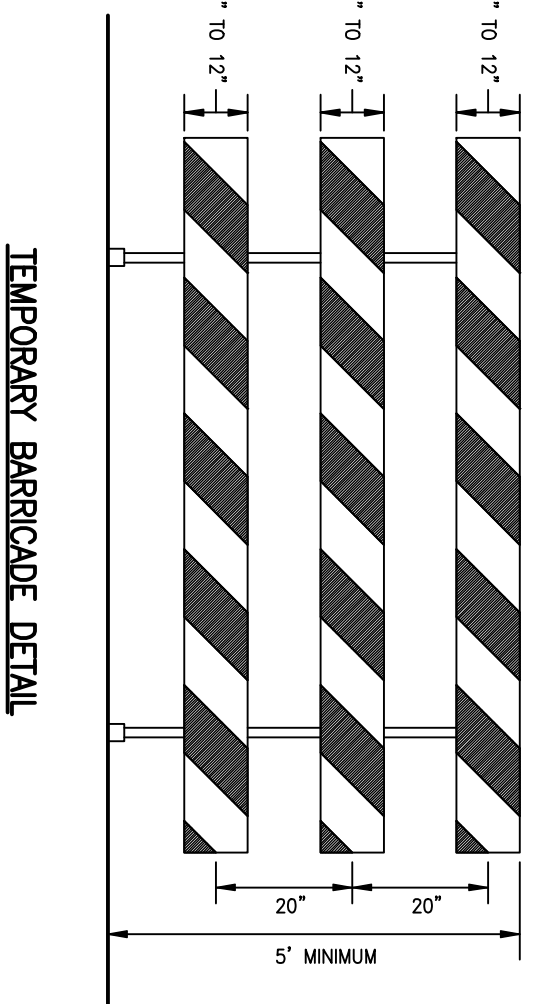

- BOARDWALK CONSTRUCTION NOTES
1. ALL SCREWS ARE TO BE GALVANIZED TAMPER RESISTANT SCREWS.
  2. ALL SCREWS ARE TO BE GALVANIZED TAMPER RESISTANT SCREWS.
  3. ALL HARDWARE IS TO BE GALVANIZED.

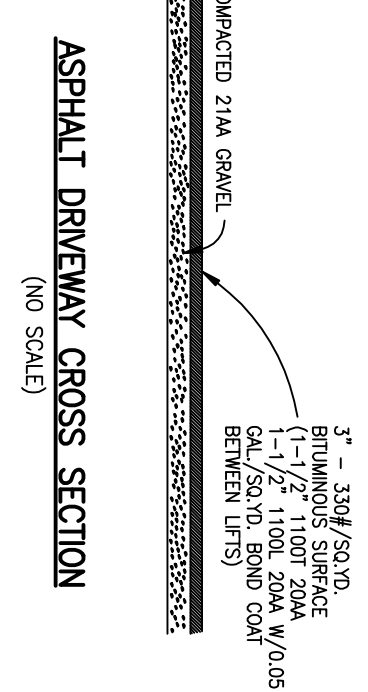
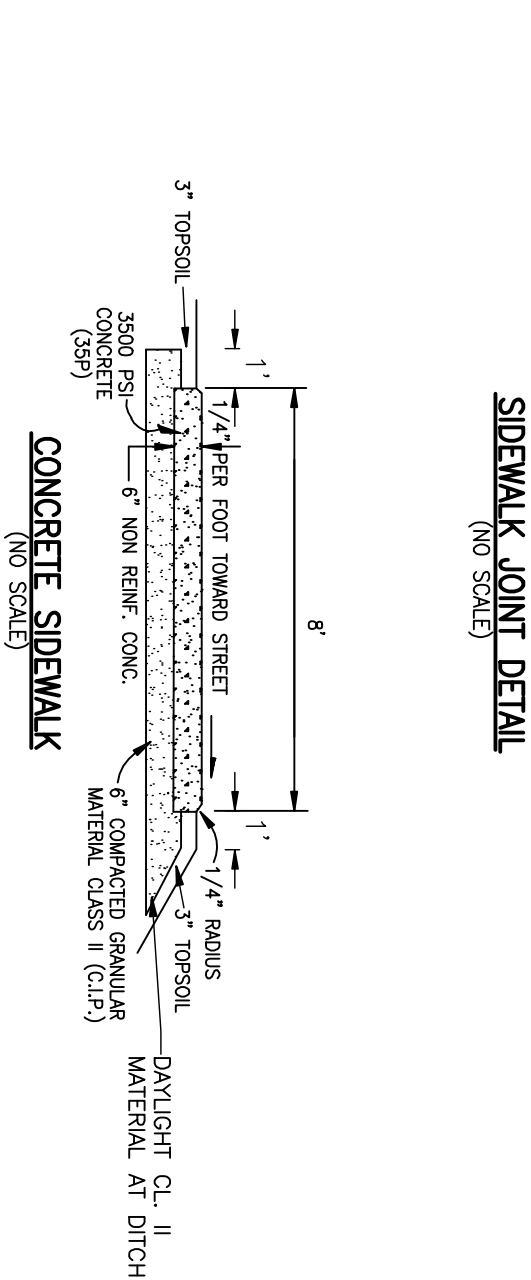
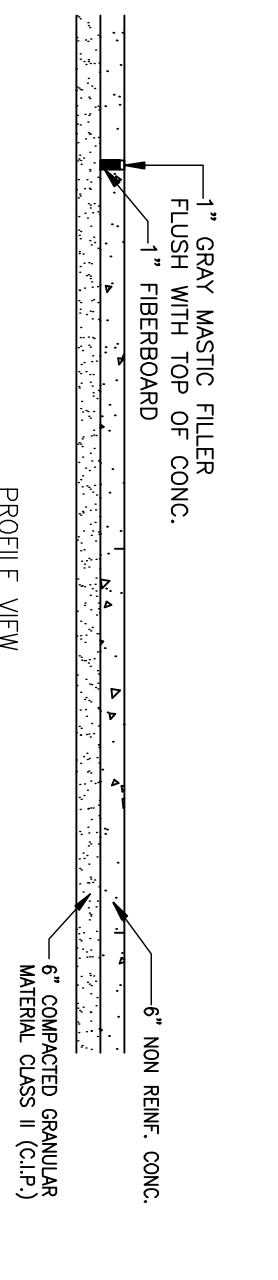
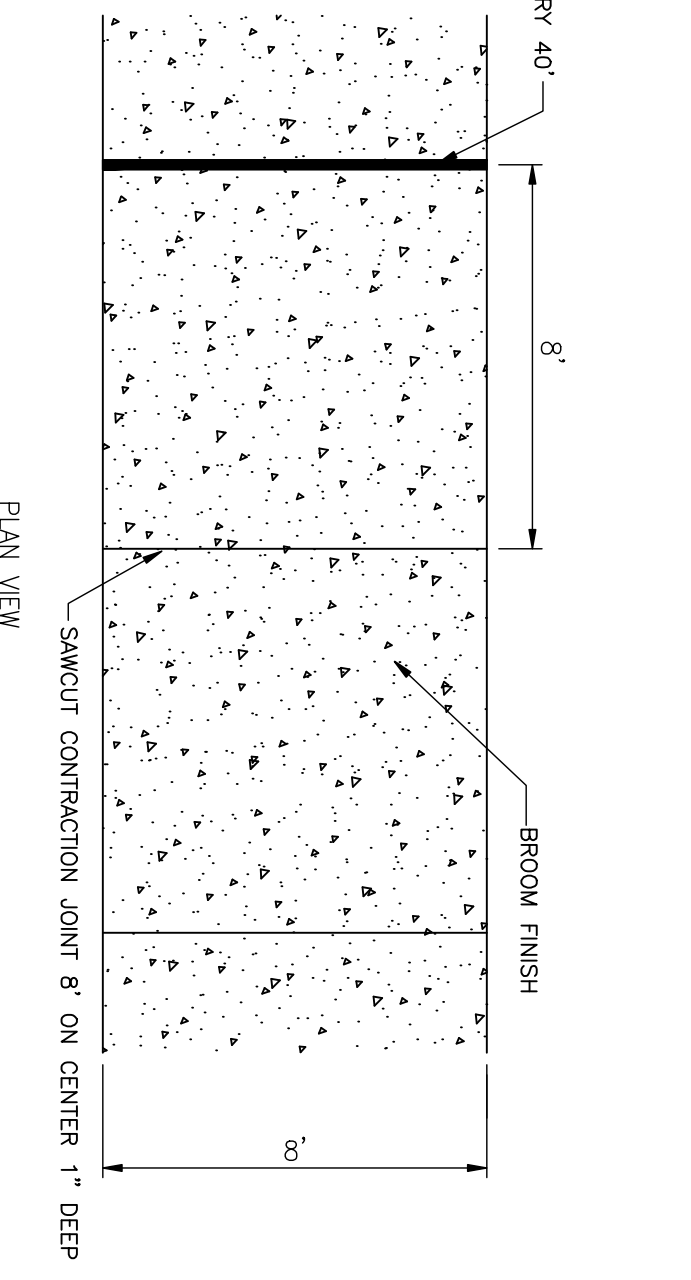
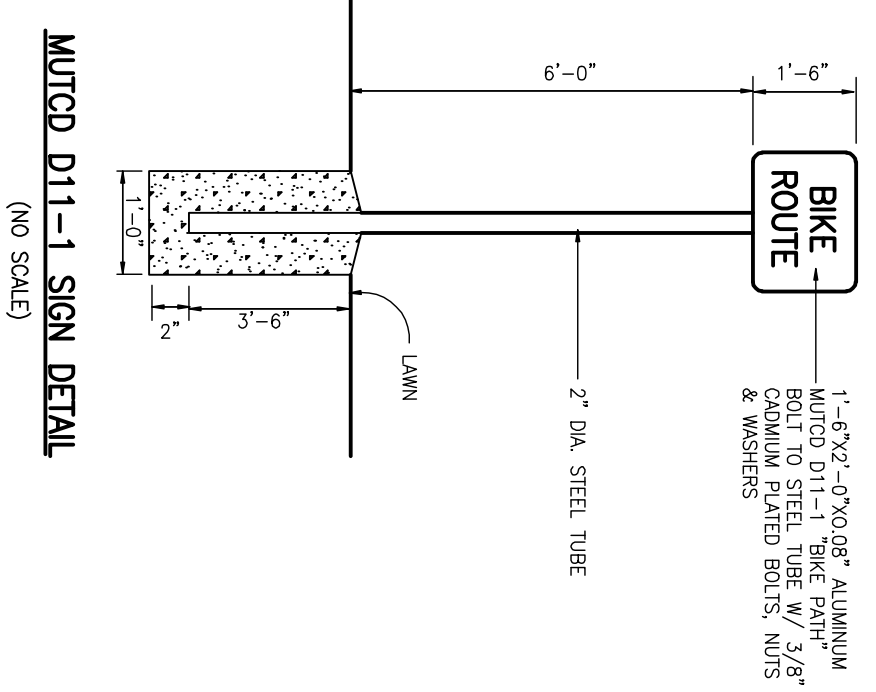
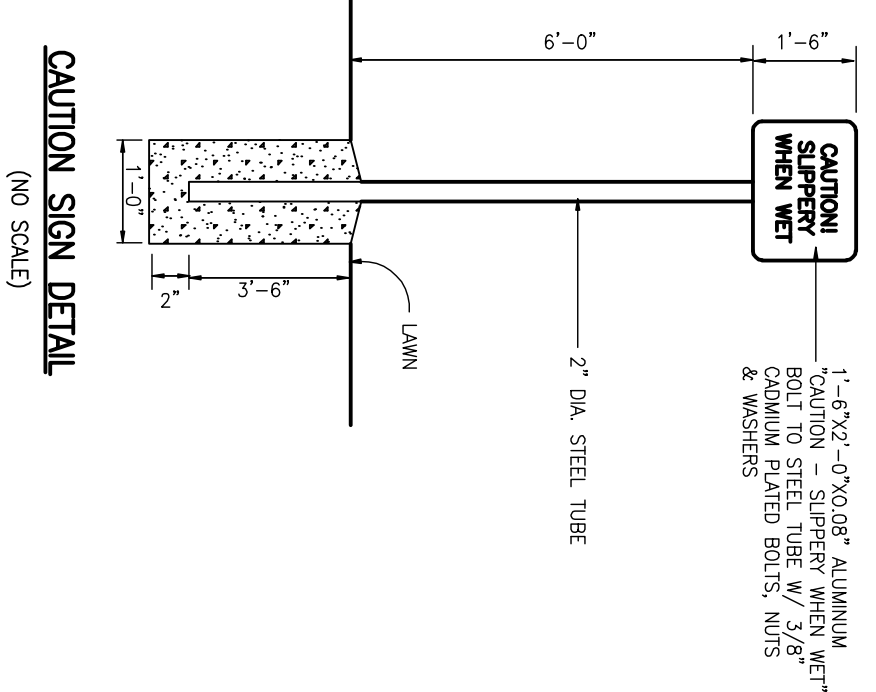
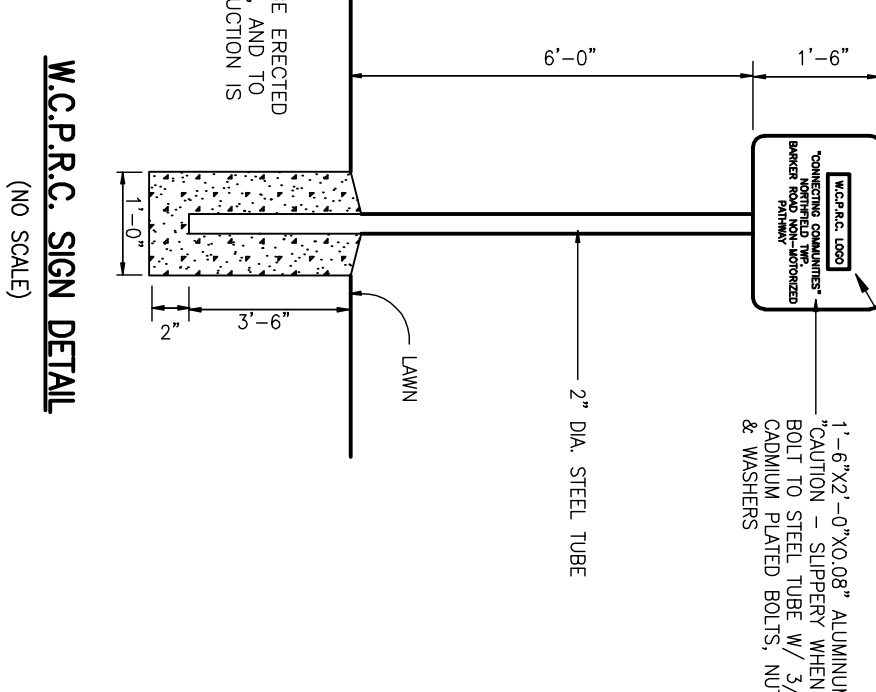
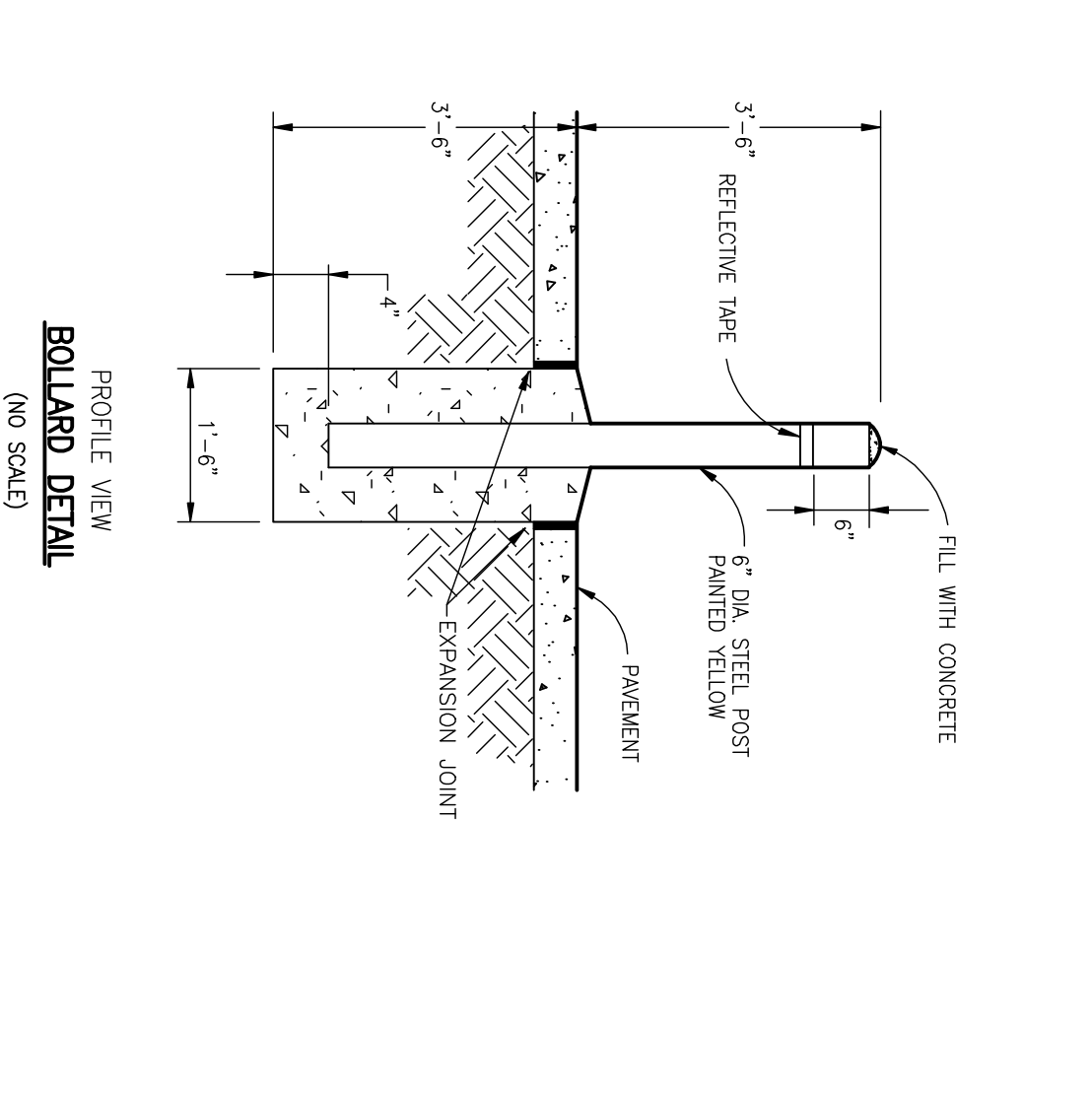
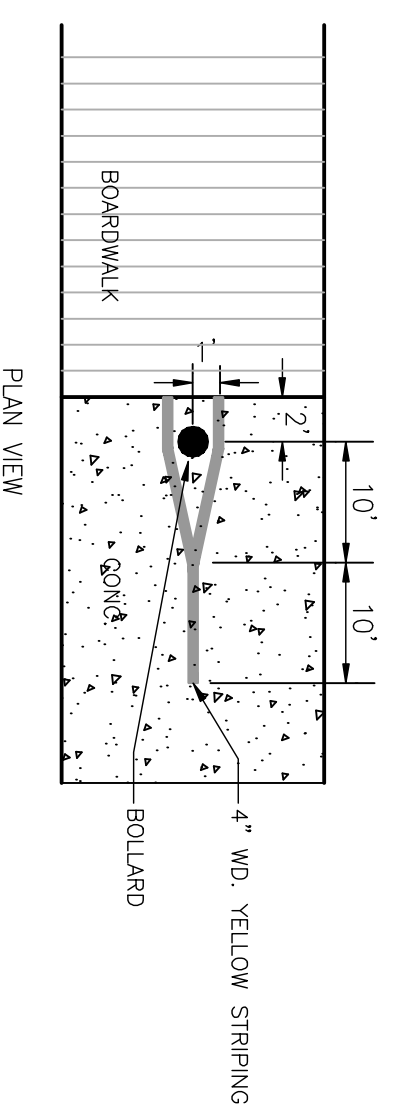
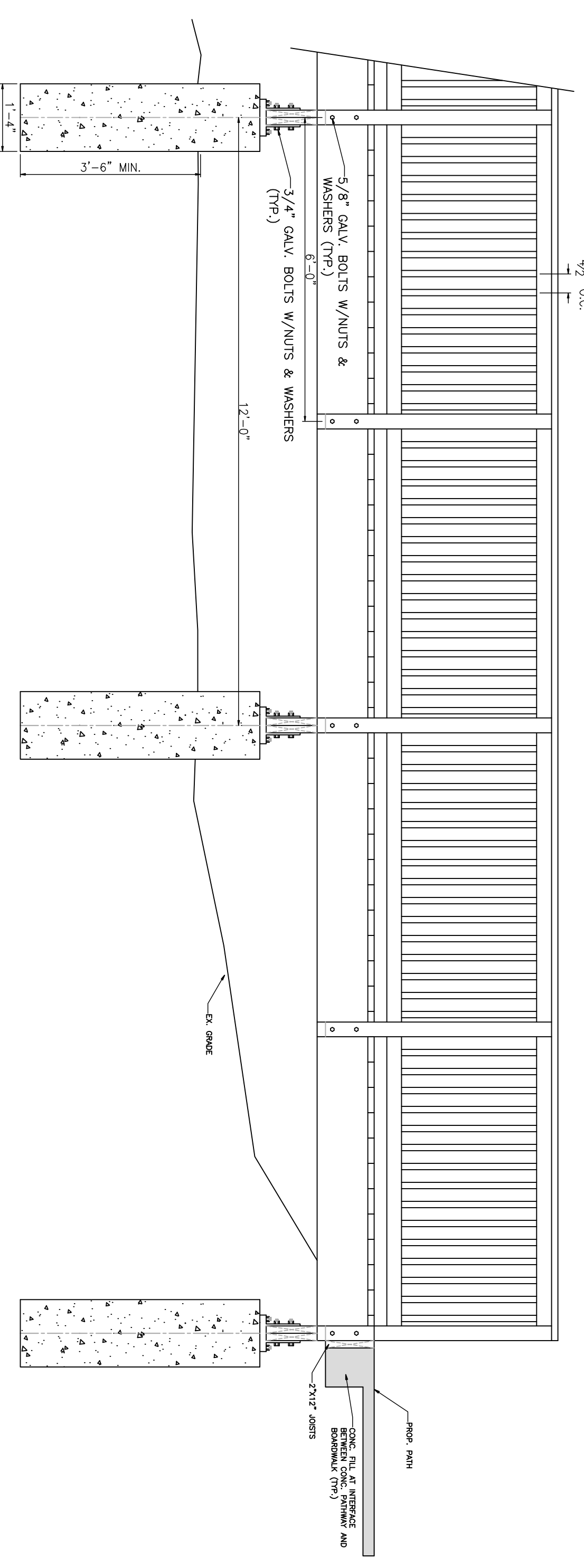
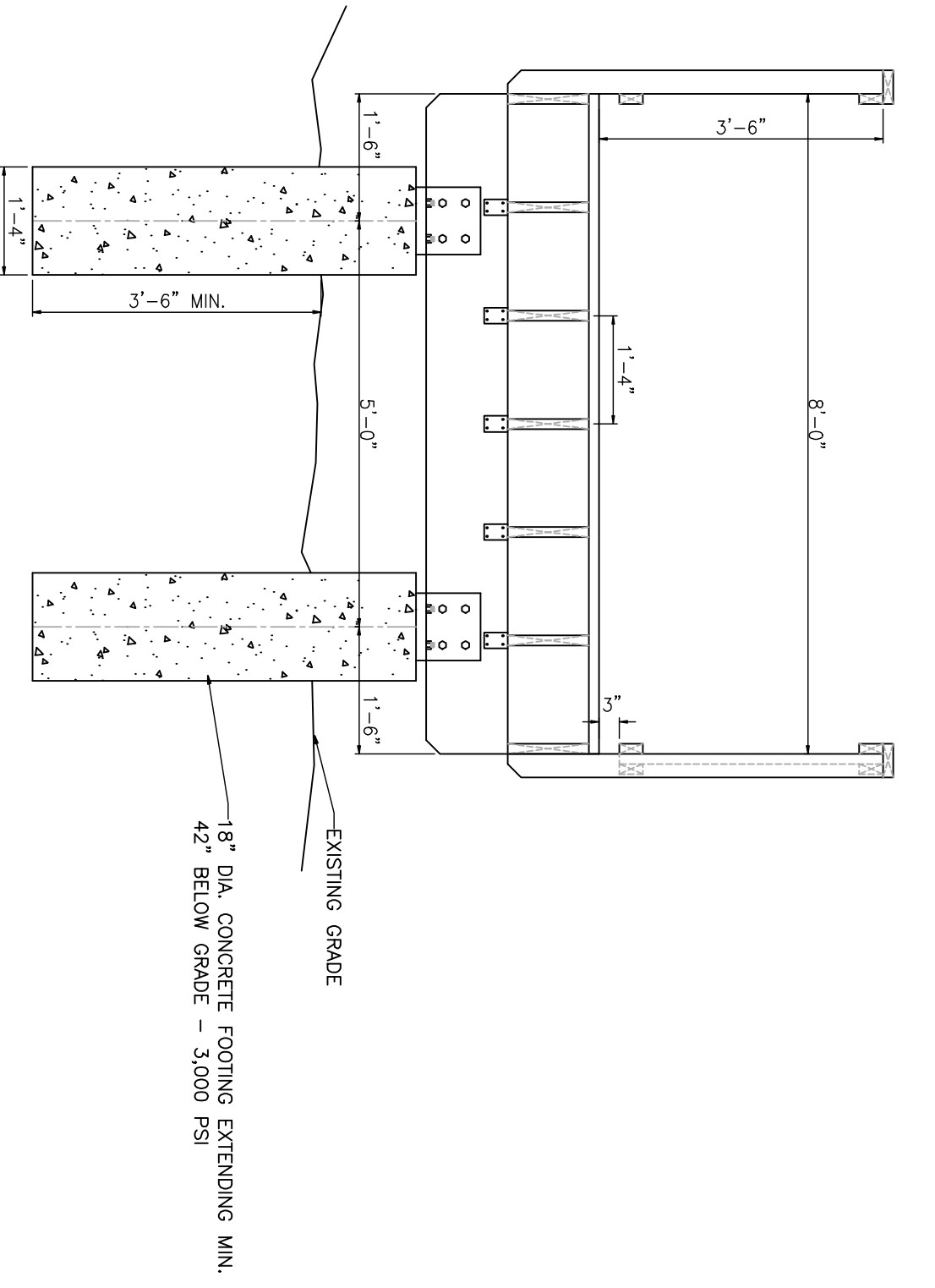

THE LOCATION AND ELEVATION OF EXISTING UNDERGROUND UTILITIES AS SHOWN ON THESE DRAWINGS ARE ONLY APPROXIMATE. NO GUARANTEE IS EITHER EXPRESSED OR IMPLIED AS TO THE COMPLETENESS OR ACCURACY THEREOF. THE CONTRACTOR SHALL BE EXCLUSIVELY RESPONSIBLE FOR DETERMINING THE EXACT LOCATION AND ELEVATION OF EXISTING UTILITIES AND PROPOSED UTILITY CROSSINGS IN THE FIELD PRIOR TO CONSTRUCTION. THE CONTRACTOR SHALL NOTIFY THE ENGINEER IF ANY CONFLICTS ARE APPARENT OR IF THE LOCATION OR DEPTH DIFFERS SIGNIFICANTLY FROM THE PLANS.



**BOSS ENGINEERING**  
ENGINEERS • SURVEYORS • PLANNERS  
LANDSCAPE ARCHITECTS  
(E-MAIL: [be@bosseng.com](mailto:be@bosseng.com))  
3121 E. GRAND RIVER AVE.  
HOWELL, MI. 48843  
(800) 246-6735 FAX (517) 548-1670

PROJECT:	<b>BARKER ROAD PHASE 1 NON-MOTORIZED PATHWAY</b>		
PREPARED FOR:	<b>NORTHFIELD TOWNSHIP</b>		
	8350 MAIN STREET WHITMORE LAKE, MI 48189 (734) 449-2880		
TITLE:	<b>CONSTRUCTION DETAILS</b>		
NO.	BY	FOR BIDS	DATE
1	TD	6-21-11	

DESIGNED BY:	TD
DRAWN BY:	TD
CHECKED BY:	
SCALE:	1" = 30'
JOB NO.:	10-053
DATE:	6-14-11
SHEET NO.:	5